

**Tree Descriptions**

- Trees A & B:
- 1 Both A and B are Western Hemlock (*Tsuga heterophylla*) approx. 80' tall with a diameter of 6.75" and 7".
  - 2 Both trees are standing dead and pose a hazard to the adjacent lot.
  - 3 Shoreline Exemption seeks to remove these two trees, as categorically exempt WAC 197-040

Andrew T Engel

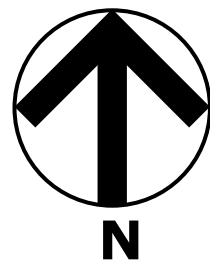



Trees A & B Western Hemlock (*Tsuga heterophylla*)



Trees A & B Western Hemlock (*Tsuga heterophylla*)

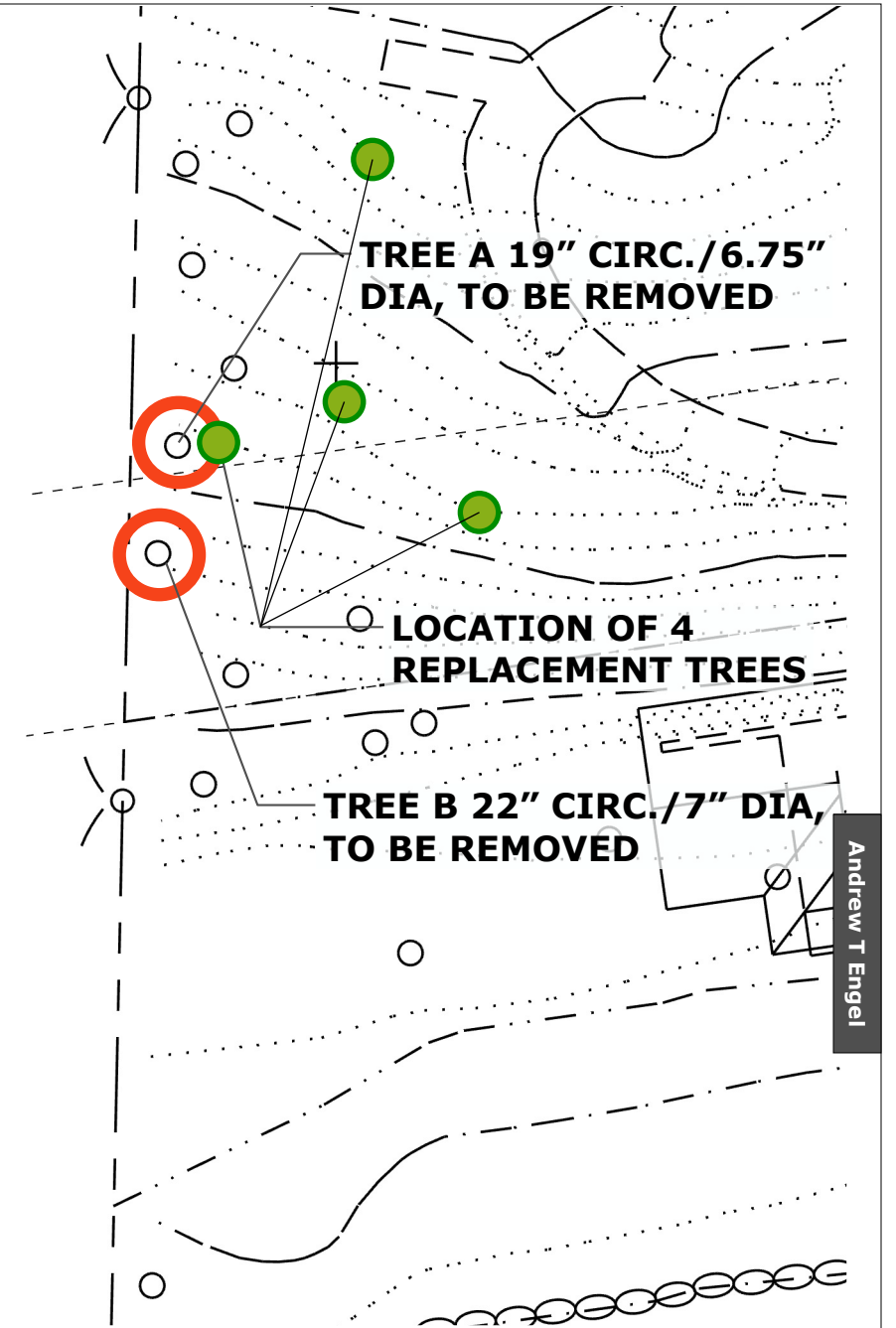

Lake Washington

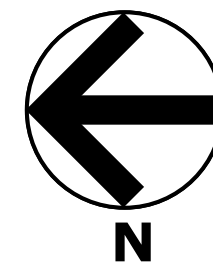



Trees A & B Western Hemlock (*Tsuga heterophylla*)



Trees A & B Western Hemlock (*Tsuga heterophylla*)

Photos indicate arborist measurement of Tree B, and evidence of disease at base of tree.